

Cluster solid stream nozzles for air or saturated steam

Series 540/541



Features:

- Powerful round jet through 40 individual bore holes
- Delivery of media at an angle of approx. 240°
- Suitable for use in difficult conditions
- Suitable for immersion in liquid media

Applications:

- Injection of steam into liquids
- Injection of compressed air into bulk goods
- Injection of gas (acid and neutralization baths)

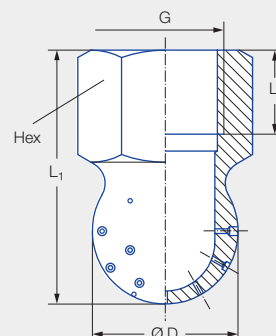
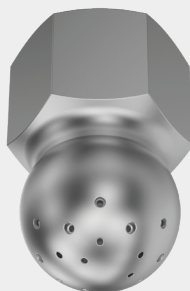

Series 540/541

G	Dimensions [mm]				Weight [g]
	L ₁	L ₂	Ø D	Hex	
1/2 BSPP	45.0	15.0	26.0	27	100.0

Spray angle	Ordering no.		Bore diameter B [mm]	V _n air [m³/h]				M saturated steam [kg/h]			
	Type	Mat. no.		p [bar]				p [bar]			
		16									
		Stainless steel 303		1.0	2.0	3.0	5.0	1.0	2.0	3.0	5.0
Approx. 240°	540.909	●	0.80	22.80	34.20	45.50	68.30	18.10	26.90	35.50	52.70
	540.989	●	1.00	35.50	53.30	71.00	106.50	28.20	41.70	55.10	81.70
	541.109	●	1.50	83.30	124.90	166.50	249.80	66.00	97.70	129.20	191.60
	541.189	●	2.00	129.70	194.50	259.30	389.00	103.00	152.60	201.70	299.10
	541.239	●	2.30	167.20	250.80	334.30	501.50	133.20	197.30	260.80	386.60

Ordering Type + Material no. = Ordering no.
example: 540.909 + 16 = 540.909.16



Assembly accessories can be found in Chapter 9 "Accessories".